

SHIP BASED DAMAGE CONTROL TRAINING

ICS

AUSTRALIA



SITE OVERVIEW

**HMAS Cerberus
Hastings, Victoria**

Damage Control
Training for naval
vessels

FEATURES

- Hull oscillation $\pm 10^\circ$
- High and low-pressure damage points
- Compartment flooding up to 1.8m
- Water capture and treatment
- Watertight doors and hatches
- CCTV & damage sound effects
- Casualty power system training

ICS AUSTRALIA

P.O Box 578
Wangaratta
Victoria, 3676
Australia

+61 3 5722 4900

office@icsaustralia.net

www.icsaustralia.net



ICS Australia's management system has been certified to ISO 9001

SHIP BASED DAMAGE CONTROL TRAINING

ICS

AUSTRALIA

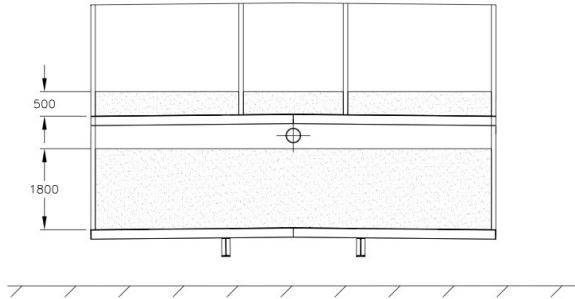

0° LIST
WATER MAXIMUM LEVEL MAINTAINED BY OVERFLOW DRAINS

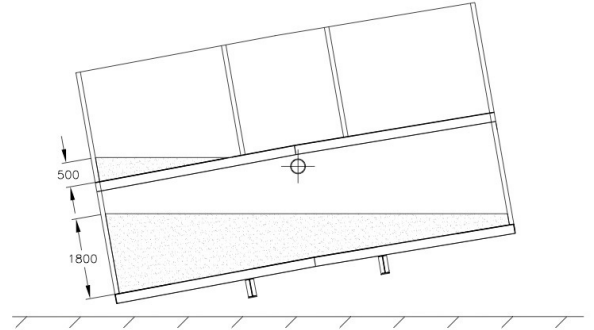

10° LIST
WATER MAXIMUM LEVEL MAINTAINED BY OVERFLOW DRAINS

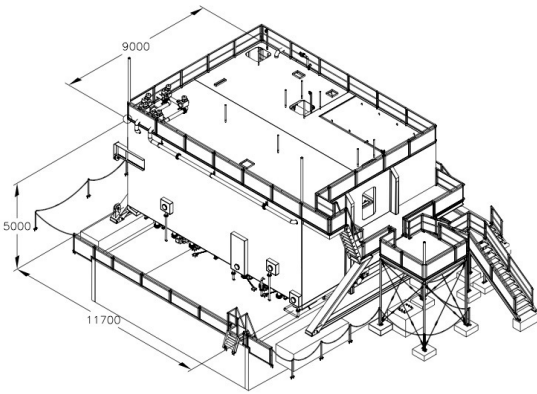

TOP DECK

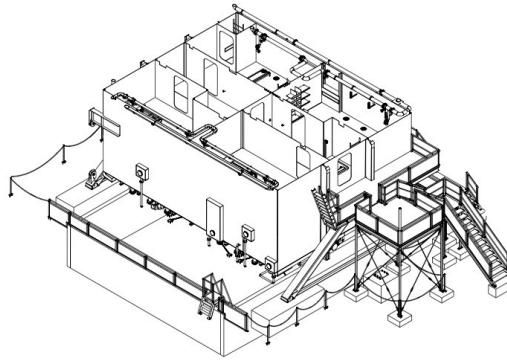

MID DECK

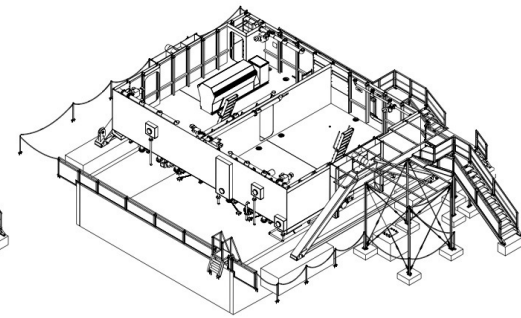

LOWER DECK

Hull roll & compartment flooding limits and maximum water height

SPECIFICATIONS

Movement

- Static and dynamic List $\pm 10^\circ$
- Full oscillation (40° total roll) period less than 1 minute
- Hydraulic power and actuators supplied by Bosch Rexroth

Water level

- Real-time level sensors for each compartment
- Overflows prevent the maximum water level from being exceeded

Control

- Full SCADA control of the unit operation

Leaks

- Modulation of leak intensity
- Doors and hatches
- Structural damage
- Incident damage
- Pipework and valves

Safety

- Compartment drainage in 3 minutes.
- Hull exits to lower and mid-deck platforms
- Emergency stop located on the hull & platforms
- Redundant water supply isolation
- Drain valves are fail-open

